

Urethane Modular Backup Rings - Inch

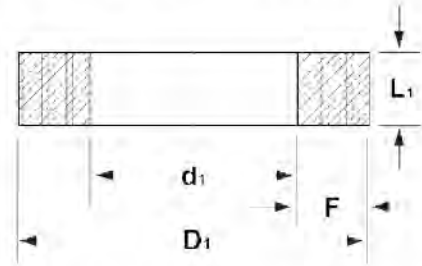

EXAMPLE: 25002750-MB

Cross Section	Inside Diameter	Suffix
250	02750	- MB
1/4"	2-3/4"	

Made from 65 D durometer urethane, these devices are designed to absorb shock loads and are used to prevent extrusion of loaded lip seals at high pressure. Please contact Sales for other compounds and sizes. Parts with a 4652 suffix are manufactured from polymite.

Temperature: -65° to 200°F

Part Number	Inside Dia. d_1	Outside Dia. D_1	Height L_1
1/8" CROSS SECTION ("F")			
12500250-MB	0.250	0.500	0.125
12500312-MB	0.312	0.562	0.125
12500500-MB	0.500	0.750	0.125
12500625-MB	0.625	0.875	0.125
12500687-MB	0.687	0.937	0.125
12500812-MB	0.812	1.062	0.125
12500937-MB	0.937	1.187	0.125
12501000-MB	1.000	1.250	0.125
12501375-MB	1.375	1.625	0.125
12501500-MB	1.500	1.750	0.125
3/16" CROSS SECTION ("F")			
18701250-MB	1.250	1.625	0.187
18701500-MB	1.500	1.875	0.187
18701625-MB	1.625	2.000	0.187
18701875-MB	1.875	2.250	0.187
18702000-MB	2.000	2.375	0.187
18702500-MB	2.500	2.875	0.187
18702625-MB	2.625	3.000	0.187
18702750-MB	2.750	3.125	0.187
18703000-MB	3.000	3.375	0.187
18703250-MB	3.250	3.625	0.187
18703500-MB	3.500	3.875	0.187

Part Number	Inside Dia. d_1	Outside Dia. D_1	Height L_1
1/4" CROSS SECTION ("F")			
25000875-MB	0.875	1.375	0.250
25001000-MB	1.000	1.500	0.250
25001250-MB	1.250	1.750	0.250
25001375-MB	1.375	1.875	0.250
25001500-MB	1.500	2.000	0.250
25001750-MB	1.750	2.250	0.250
25002000-MB	2.000	2.500	0.250
25002250-MB	2.250	2.750	0.250
25002500-MB	2.500	3.000	0.250
25002750-MB	2.750	3.250	0.250
25002875-MB	2.875	3.375	0.250
25003000-MB	3.000	3.500	0.250
25003500-MB	3.500	4.000	0.250
25003750-MB	3.750	4.250	0.250
25004000-MB	4.000	4.500	0.250
25004250-MB	4.250	4.750	0.250
25004500-MB	4.500	5.000	0.250
25005000-MB	5.000	5.500	0.250
25005250-187MB	5.250	5.750	0.187
25005250-MB	5.250	5.750	0.250
25005500-MB	5.500	6.000	0.250
25007500-MB	7.500	8.000	0.250
25007750-MB	7.750	8.250	0.250

Urethane Modular Backup Rings - Inch, cont'd.

Part Number	Inside Dia. d ₁	Outside Dia. D ₁	Height L ₁
5/16" CROSS SECTION ("F")			
31201250-MB	1.250	1.875	0.312
31201500-MB	1.500	2.125	0.312
31201750-MB	1.750	2.375	0.312
31202000-MB	2.000	2.625	0.312
31202500-MB	2.500	3.125	0.312
31203000-MB	3.000	3.625	0.312
31203125-MB	3.125	3.750	0.312
31203500-MB	3.500	4.125	0.312
31204125-MB	4.125	4.750	0.312
31204375-MB	4.375	5.000	0.312
31204500-MB	4.500	5.125	0.312
31205375-MB	5.375	6.000	0.312
3/8" CROSS SECTION ("F")			
37501250-MB	1.250	2.000	0.375
37501500-MB	1.500	2.250	0.375
37501750-MB	1.750	2.500	0.375
37502000-MB	2.000	2.750	0.375
37502250-MB	2.250	3.000	0.375
37502375-MB	2.375	3.125	0.375
37502500-MB	2.500	3.250	0.375
37502625-MB	2.625	3.375	0.375
37502750-MB	2.750	3.500	0.375
37502750-250MB	2.750	3.500	0.250
37503000-MB	3.000	3.750	0.375
37503500-MB	3.500	4.250	0.375
37503750-MB	3.750	4.500	0.375
37504250-MB	4.250	5.000	0.375
37504500-MB	4.500	5.250	0.375
37504750-MB	4.750	5.500	0.375
37505000-250MB	5.000	5.750	0.250
37505000-MB	5.000	5.750	0.375
37505250-MB	5.250	6.000	0.375
37506000-MB	6.000	6.750	0.375
37506250-MB	6.250	7.000	0.375
37506500-MB	6.500	7.250	0.375

Part Number	Inside Dia. d ₁	Outside Dia. D ₁	Height L ₁
3/8" CROSS SECTION ("F")			
37507000-MB	7.000	7.750	0.375
37507250-MB	7.250	8.000	0.375
37507500-MB	7.500	8.250	0.375
37507750-MB	7.750	8.500	0.375
37508000-MB	8.000	8.750	0.375
37509000-MB	9.000	9.750	0.375
37509250-MB	9.250	10.000	0.375
37511000-MB	11.000	11.750	0.375
37511250-MB	11.250	12.000	0.375
7/16" CROSS SECTION ("F")			
43703875-266MB	3.875	4.750	0.266
1/2" CROSS SECTION ("F")			
50002000-MB	2.000	3.000	0.500
50002250-MB	2.250	3.250	0.500
50002500-MB	2.500	3.500	0.500
50003000-MB	3.000	4.000	0.500
50003500-MB	3.500	4.500	0.500
50004000-MB	4.000	5.000	0.500
50004500-MB	4.500	5.500	0.500
50005000-MB	5.000	6.000	0.500
50005500-MB	5.500	6.500	0.500
50006000-MB	6.000	7.000	0.500
50007000-MB	7.000	8.000	0.500
50008000-MB 4652	8.000	9.000	0.500
50008500-MB	8.500	9.500	0.500
50009000-MB	9.000	10.000	0.500
50009500-MB	9.500	10.500	0.500
50010000-MB	10.000	11.000	0.500
50010500-MB 4652	10.500	11.500	0.500
50011500-MB	11.500	12.500	0.500
50012000-MB	12.000	13.000	0.500
50013500-MB	13.500	14.500	0.500
50019000-MB	19.000	20.000	0.500
5/8" CROSS SECTION ("F")			
62512750-MB	12.750	14.000	0.625